

RENEGADE

Vacuum Cleaner

RWV25L

RWV30L

25L
Tank
Capacity

30L
Tank
Capacity



INSTRUCTION MANUAL



**Read through carefully
and understand these
instructions before use**

■ SAFETY INFORMATION

WARNING

To reduce the risk of injury, all operators and maintenance personnel must read and understand these instructions before operating, changing accessories or performing any maintenance work on this machine. All possible situations cannot be covered in these instructions, however care & common sense must be used by everyone using, maintaining or working near this equipment.

- When using electrical appliances, you must follow basic safety precautions to prevent property damage or injury.
- DO NOT use this machine improperly or for any unintended operations. This will void your warranty and the manufacturer is not liable for any damages resulting from improper or inappropriate use of this machine.
- Before use, check that the local power supplies electrical voltage is correct for the machine before use.
- DO NOT use the air outlet directly against animals or other people when using this machine.
- DO NOT use the machine near flammable or toxic substances such as fuel, oil, acids or any other volatile substances.
- DO NOT use the machine to vacuum combustible, explosive or sharp objects such as cigarettes, hot ashes or nails etc.
- DO NOT store the machine in strong, direct sunlight or any high temperature areas to reduce distortion.
- DO NOT use a cleaning agent or detergent containing solvent to clean the machine or filter.
- Unauthorized parts or third party accessories may be dangerous to make the warranty invalid.
- Turn off the machine and unplug it from the power socket before conducting any cleaning or removing accessories.
- DO NOT use this machine in a damp or wet room.
- DO NOT inhale dangerous gases or dust while using this machine. Wear appropriate Personal Protective Equipment (PPE)
- DO NOT overturn the machine. If water gets into the motor, it will cause significant damage. This will void your warranty.
- DO NOT immerse the barrel cap into water or was with water in case water gets into the electrical components and causes damage or injury. Use a damp cloth to clean and wipe dirty parts gently.
- Do not allow the lid part to penetrate into the water or rinse with water to prevent water from entering the electronic parts. Leakage, proper operation: gently wipe the surface with a rag
- DO NOT overly bend or elongate the hose beyond its reasonable limits, as this will damage and deform the hose.

WARNING

If the power cord is damaged, it must be replaced by the manufacturer or an authorised service agent. DO not use the machine if the power cord is damaged.

PARTS NAME

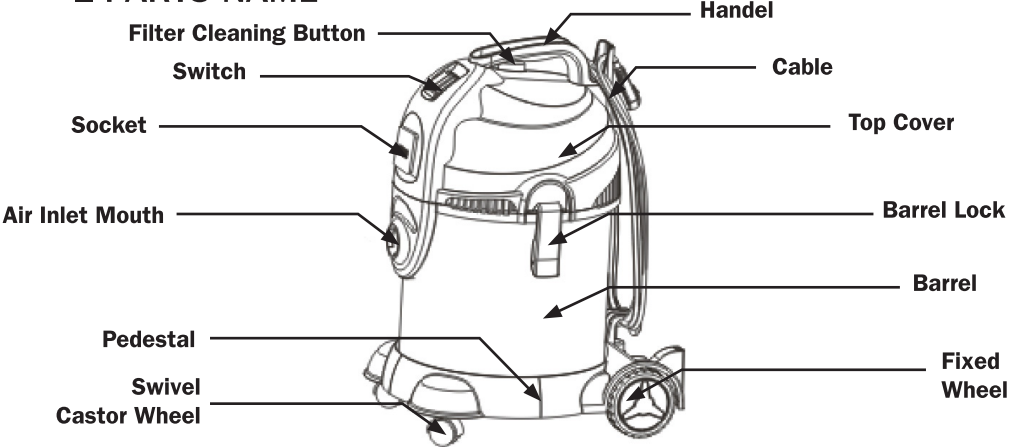

ACCESSORIES

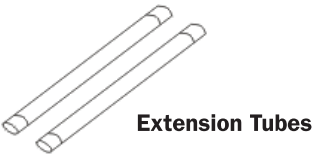
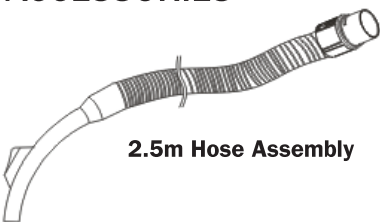

OPTIONAL ACCESSORIES

5 pack paper bag (code: RWVPB5)

TECHNICAL SPECIFICATIONS

MODEL	RWV25L	RWV30L
TANK Capacity	25W	300W
RATED POWER	1400W	1400W
VOLTAGES/FREQUENCY	240V / 50Hz	240V / 50Hz
FILTER	HEPA	HEPA
HOSE	2.5m	2.5m

■ OPERATION

1. Make sure that the power cord is disconnected from the local power supply and the machine is off.
2. Insert the hose connector into the air inlet mouth as shown. Make sure the connector is tightly fastened.
3. Press the connector button and pull the connector out when you want to remove the hose from the machine.
4. Connect all the accessories as shown below.

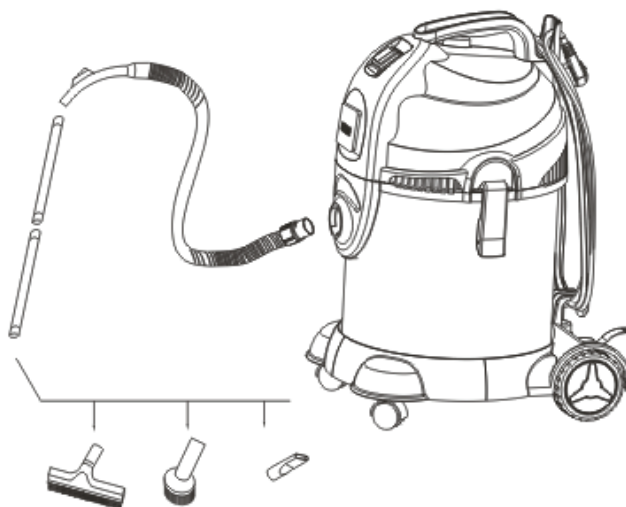
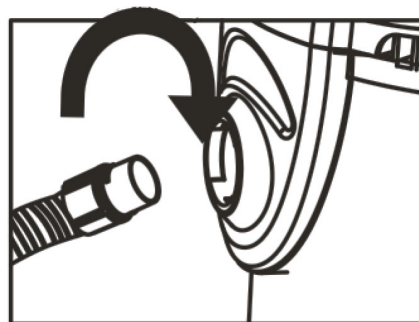

FILTER CLEANING SYSTEM

1. If the suction is weak during use, put your hand against the hose and then press the filter cleaning button 10 – 15 times.

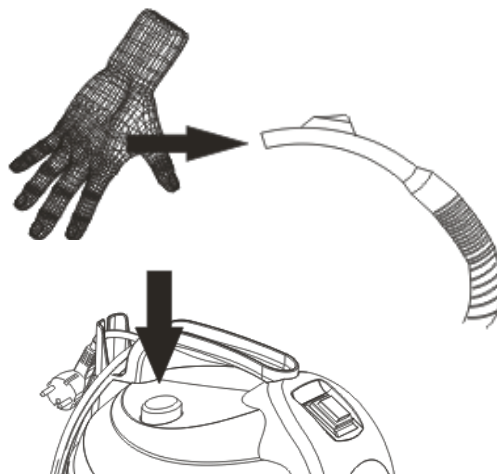

2. Dust attached to the filter will cause reduced or weak suction. High suction can be restored when the filters have been cleaned with the filter cleaning function.

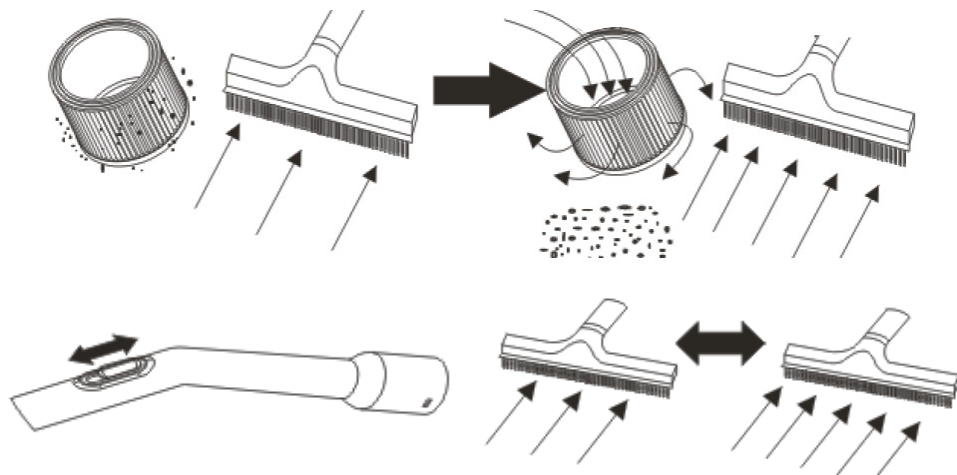

SWITCH AND SOCKET OPERATION

1. When you want to use the socket function, open the lid and insert the plug into the socket.
2. When you press the switch button, the machine will begin to work.
 - a. "I" will turn the machine on, and the socket will not be live.
 - b. "O" will turn the machine off, and the socket will not be live.
 - c. "II" will turn the machine on, and the socket will be live.
 - d. The machine will stop working after the outer facility is turned off for 5 – 8 seconds

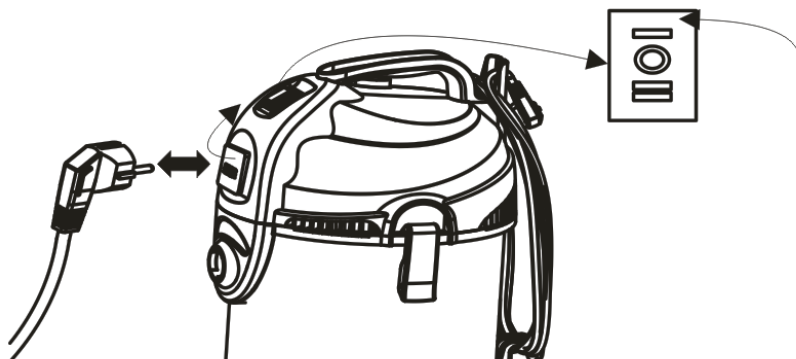

■ MAINTENANCE

1. Check the barrel and filter and related accessories regularly. After each use, wash and dry the filter if necessary. The filter should be washed with warm, clean water only. DO NOT use a wet filter all the time.
2. Check the plug and power cord for any damage.
3. Check for objects that may have jammed the air inlet mouth after suctioning water.
4. Keep the machine in a dry environment away from direct sunlight.
5. DO NOT use the machine for a continuous period greater than two hours.
6. Stop using the machine if any abnormal shaking, noise or smells occur.

■ MAINTENANCE FOR BARREL AND FILTER

1. BARREL CLEANING

- a. Unfasten the barrel locks and lift the top cover off the machine.
- b. Take off the filter bag, shake and remove the dust.
- c. Reinstall the filter bag back into the machine and replace the top cover.

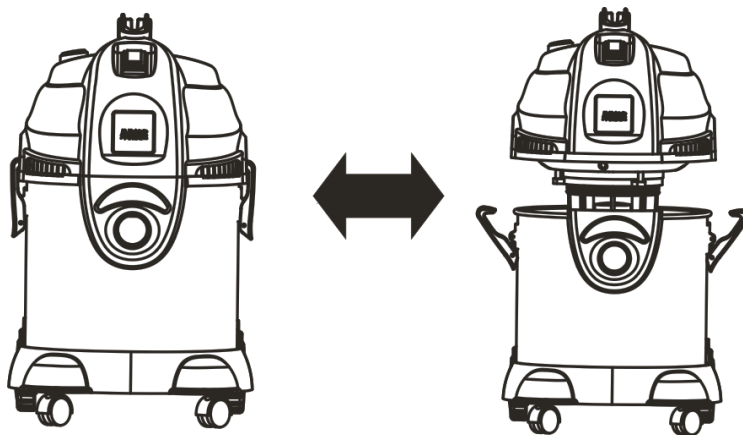

2. FILTER BAG CLEANING.

The filter bag should be washed and cleaned with warm water when it is dirty.

- a. Remove the filter.
- b. Wash with clean, warm water only. Do not use a detergent or solvent.
- c. Dry the filter before returning it into the machine.



■ **NOTES**

RENEGADE

**TradeTools Pty Ltd
131 Quinns Hill Rd East
Stapylton, Queensland 4207
P. 07 55406400
www.tradetools.com**